



CCAWA Mandurah 2018

Sebel Hotel, Mandurah, WA, April 2018.





MARK ADRIAN FENNER
23rd June 1957 - 5th December 2011

Loved husband of Terri
Greatly missed father of
Stephanie and Nathan
Cherished Pop to many
Never more than a thought away
Loved and remembered every day

Bye for now

023













Floating Series Bronze Plaques

Pullman On The Park, Melbourne, Victoria October 2017

Flora Designs



Gum Leaf

With a range of floral designs from native Australian flowers such as the Sturt Desert Pea to traditional and elegant Roses there is a design to suit any need. These designs can be used to create stunning native gardens or rejuvenate existing memorial sections.



Frangipani



Roses



Tulips



Waratah



Lily



Carnellia



Boab Tree



Gum nut



Sturt Desert Pea





Stuart Michael Everlon

3.4.1968 - 18.5.2010

*Adored and Loving husband of Katherine
Loved uncle, brother-in-law, friend and mate
Now at peace without pain*







Thomas James Everlon

29.6.1944 - 18.9.2009

Loving and devoted husband of Sophia

Much loved and respected father of

Elizabeth, Andrew, Isabella & Stuart









Bespoke Ashes Cylinders

Pullman On The Park, Melbourne, Victoria October 2017



Artist's impression for illustration purposes only.

Ash Memorial Cylinder Design



www.everlonbronze.com.au
rodney@everlonbronze.com.au

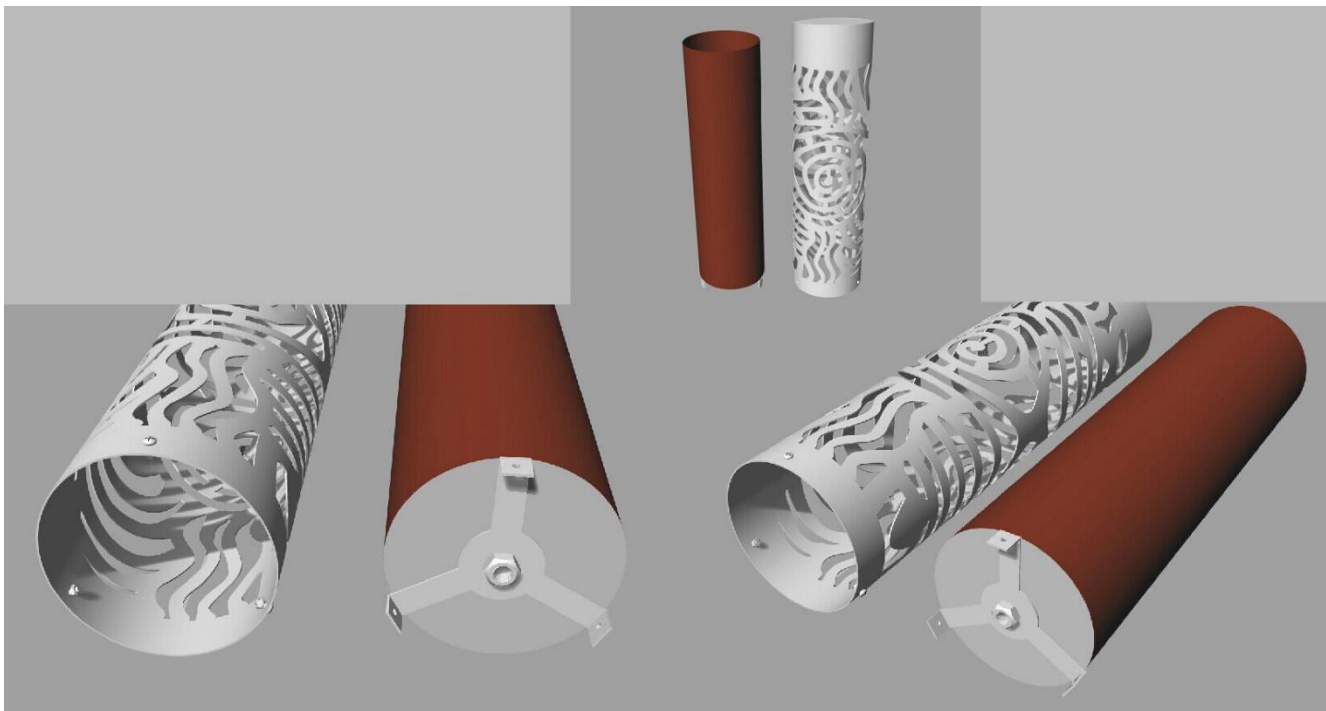







Memorial Ashes System MAS

Pullman On The Park, Melbourne, Victoria October 2017











Lifestyle Bronze Plaques

Pullman On The Park, Melbourne, Victoria October 2017



Designer Series

A picture can say a thousand words.

Lifestyle Series

Everlon believes memorialisation is more than a name and date upon a plaque.

Our new Lifestyle Series add variety and freshness to the everyday plaque designs. The lifestyle series is vast and encompasses background images reflecting the arts, religion, sports, adventures, landscapes, gourmet foods and wines. When designing the plaque, the family simply chooses one of Everlon's preselected background images that best reflected their loved ones lifestyle with the appropriate wording to be placed over the images. A loved one no longer has to be remembered by just a few lines of text, their memorial can be a true reflection of the individual thanks to the Everlon Bronze Lifestyle Series.

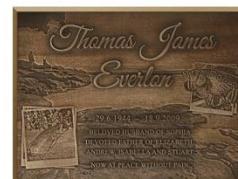
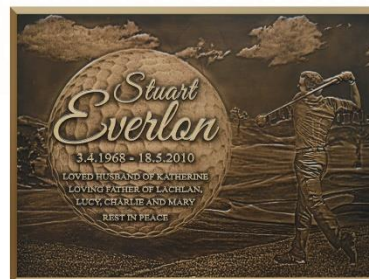

Everlon Thomas James

29. 6. 1944 – 18. 9. 2009

LOVING FATHER OF ELIZABETH,
JONATHAN, ISABELLA & STUART

ADORED GRANDFATHER OF
HIS GRANDCHILDREN

NOW AT PEACE WITHOUT PAIN



Everlon Thomas James

29.6.1944 – 18.9.2009

beloved husband of sophia
loving father of Elizabeth, Andrew,
Isabella & Stuart

now at peace without pain



Thomas James Everlon

29.6.1944 - 18.9.2009

LOVING HUSBAND OF SOPHIA
LOVED FATHER OF ELIZBETH,
ANDREW, ISABELLA AND STURAT

FOREVER IN OUR HEARTS



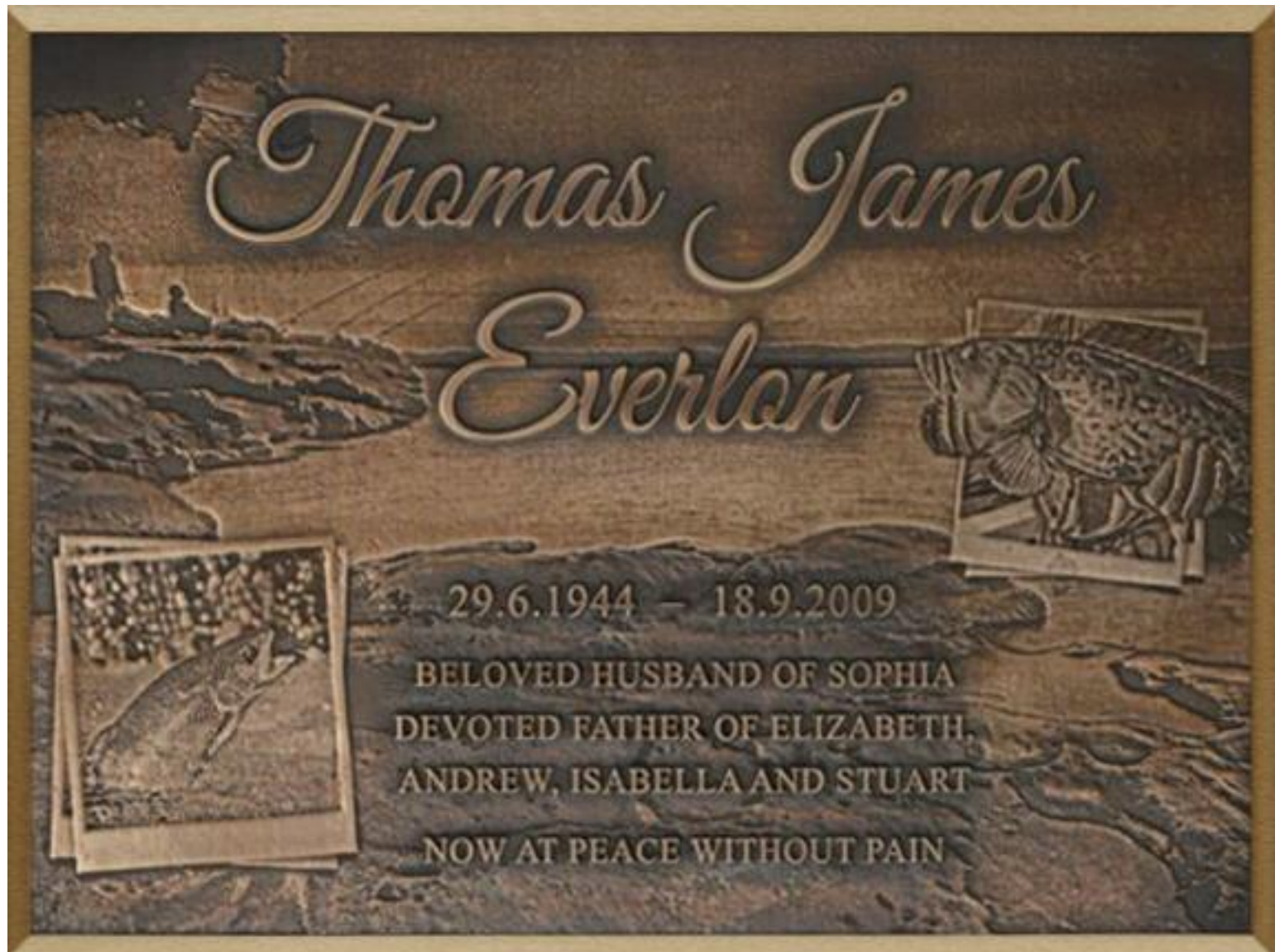

Everlon Sophia Ann

17. 3. 1948 – 2. 10. 2011

LOVING PARENTS OF ELIZABETH, JONATHAN,
ISABELLA AND STUART

ADORED GRANDPARENTS OF
THEIR GRANDCHILDREN

NOW AT PEACE WITHOUT PAIN





Everlon Thomas James

29. 6. 1944 – 18. 9. 2009

LOVING PARENTS OF
ELIZABETH, JONATHAN, ISABELLA
AND STUART

ADORED GRANDPARENTS OF
THEIR GRANDCHILDREN
NOW AT PEACE WITHOUT PAIN





Ashes Ossuarium

Pullman On The Park, Melbourne, Victoria October 2017







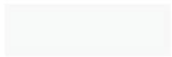





Cemetery / Section Design

Pullman On The Park, Melbourne, Victoria October 2017





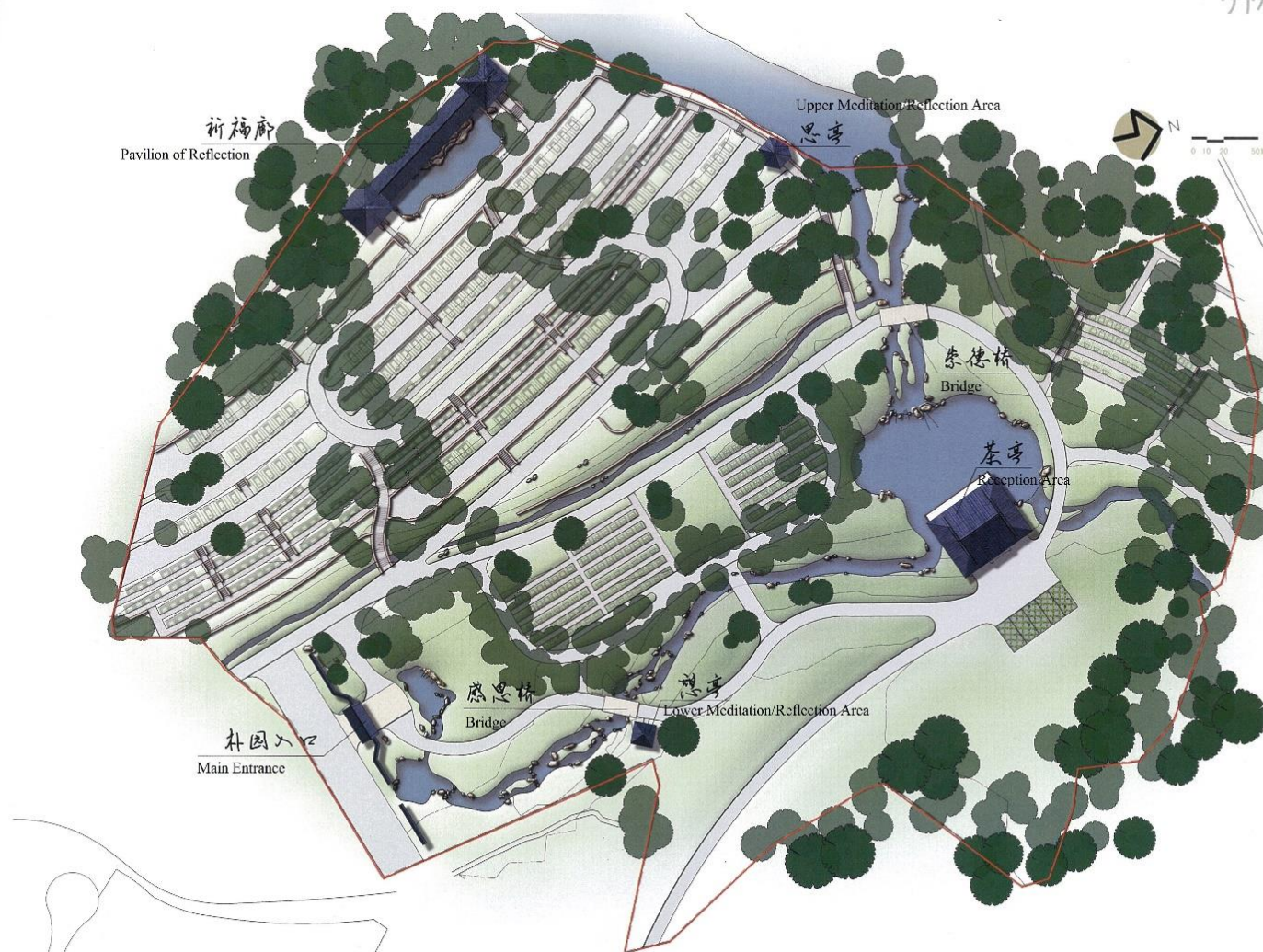









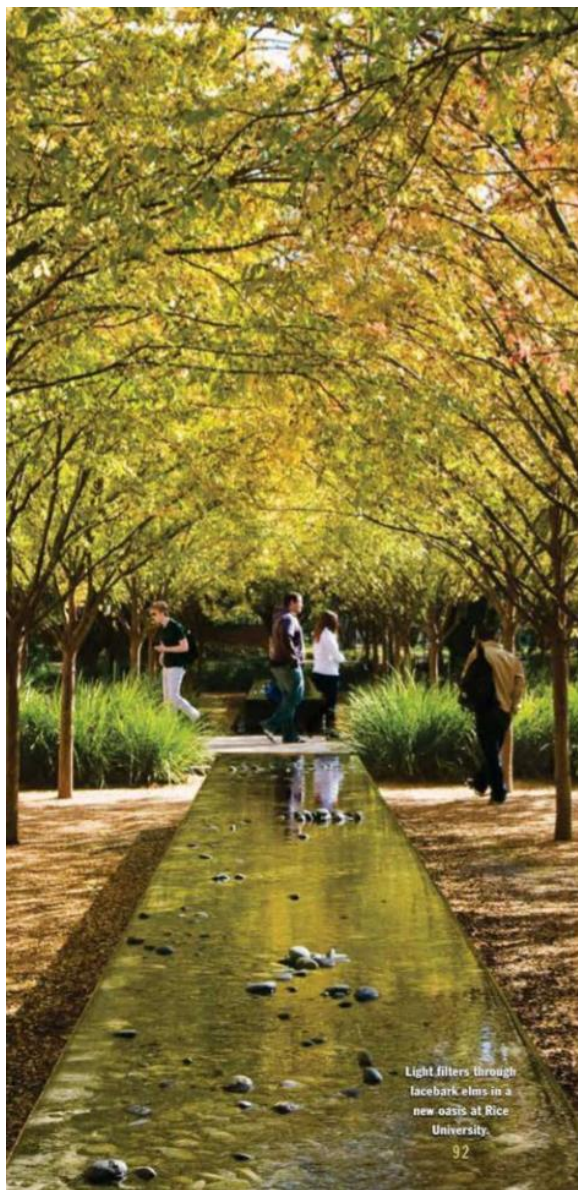

Light filters through
lacebark elms in a
new oasis at Rice
University.

92

水景 铺装 平台 细节

*
*
*





Artist's impression for illustration purposes only.

Lifestyle Ledger Series

Concept for Illustration











Cemetery Landscape Artworks

Pullman On The Park, Melbourne, Victoria October 2017























Signage

Pullman On The Park, Melbourne, Victoria October 2017







Bronze Statues

Pullman On The Park, Melbourne, Victoria October 2017

















